

LAKEWOOD CORNERS - TRACT III

LOUETTA AT ELDRIDGE PARKWAY
HARRIS COUNTY, TEXAS

SITE DATA - SCHEME 3.16.2 PROPOSED DEVELOPMENT

GROSS LAND AREA	3.2825 ACRES (142,985 S. F.)
LOTS A & B	1.7935 ACRES (78,127 S.F.)
LOT A	1.1496 ACRES (50,076 S.F.)
GROSS BUILDING AREA	13,000 S.F.
PARKING	
PARKING SPACES	68 AUTOMOBILES (3 ACCESSIBLE)
PARKING RATIO	5.23 AUTOS/MGLA
LOT B	0.6440 ACRES (28,051 S.F.)
PAD BUILDING AREA	2,350 S.F.
PARKING	
PARKING SPACES	37 AUTOMOBILES (2 ACCESSIBLE)
PARKING RATIO	15.74 AUTOS/MGLA
LOTS D & C	1.4889 ACRES (64,858 S.F.)
GROSS BUILDING AREA	11,957 S.F.
PARKING	
PARKING SPACES	66 AUTOMOBILES (4 ACCESSIBLE)
PARKING RATIO	5.52 AUTOS/MGLA

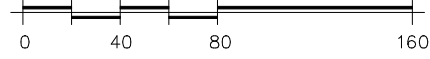
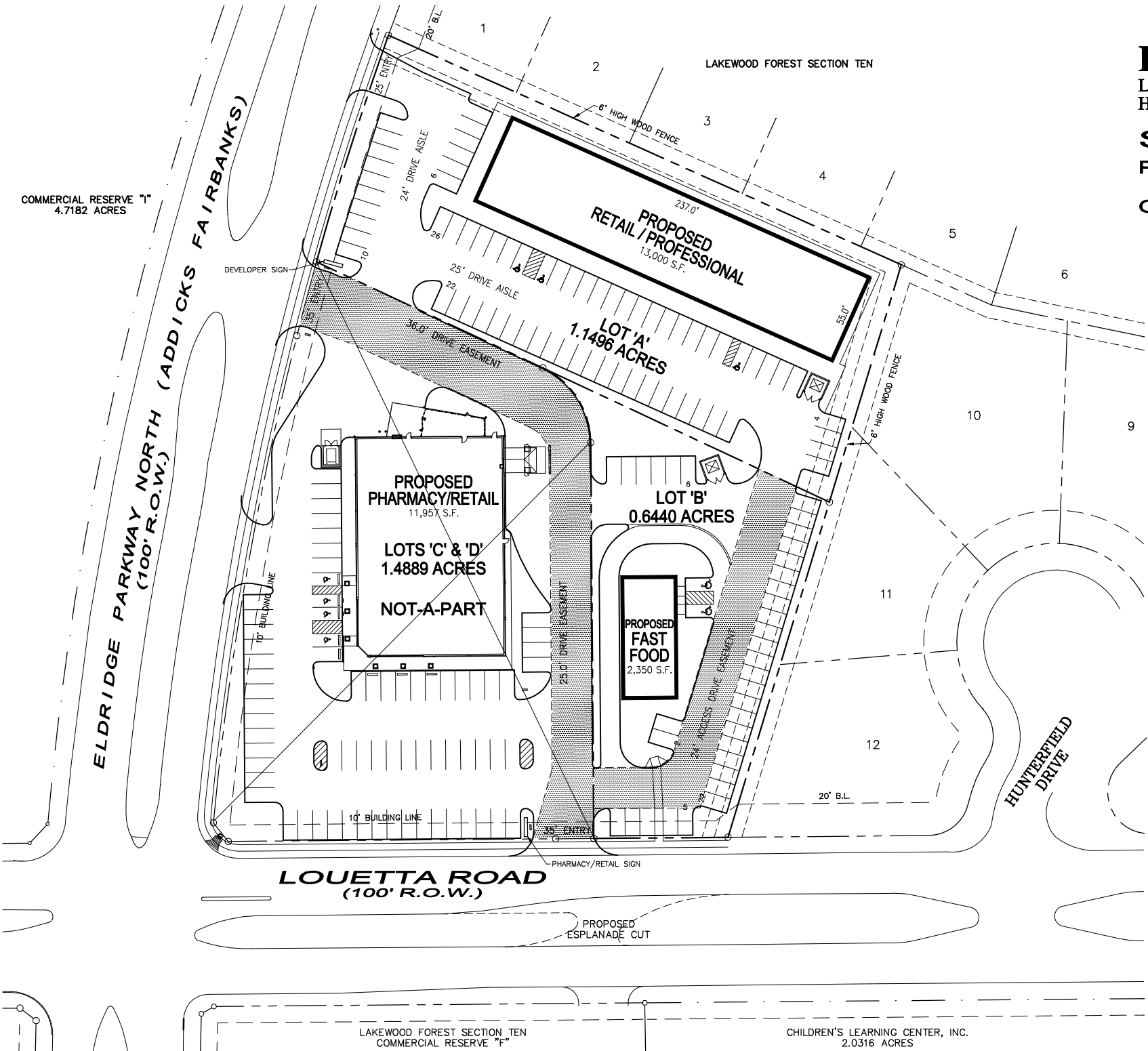

DATE: 5/2/2002



**CONCORDE REALTY
DEVELOPMENT**

2401 FOUNTAINVIEW, SUITE 500
HOUSTON, TEXAS 77057
(713) 789-3600