

Greatwood Retail Development

Sansbury Boulevard at Crabb River Road, Ft. Bend Co., Texas

A Project of Concorde Realty Development

2401 Fountainsview, Suite 500
Houston, Texas 77057
(713) 789-3600

Site Data:

Gross Land Area	4.252 ac
C7-B Retail Center	1.401 ac
C7-C Tract 1 Daycare	2.112 ac
C7-C Tract 2 Lube + Tune	.739 ac
C7-A Convenience Store	Not a Part

Leasable Area:

C7-B Retail Center	14,145 sq. ft.
--------------------	----------------

Parking/Ratios:

Total Parking Spaces	126 (5 HC): 3.90/1000 avg.
C7-B Retail Center	70 (3 HC): 4.95/1000
C7-C Tract 1 Daycare	37 (1 HC): 2.49/1000
C7-C Tract 2 Lube + Tune	19 (1 HC): 5.76/1000

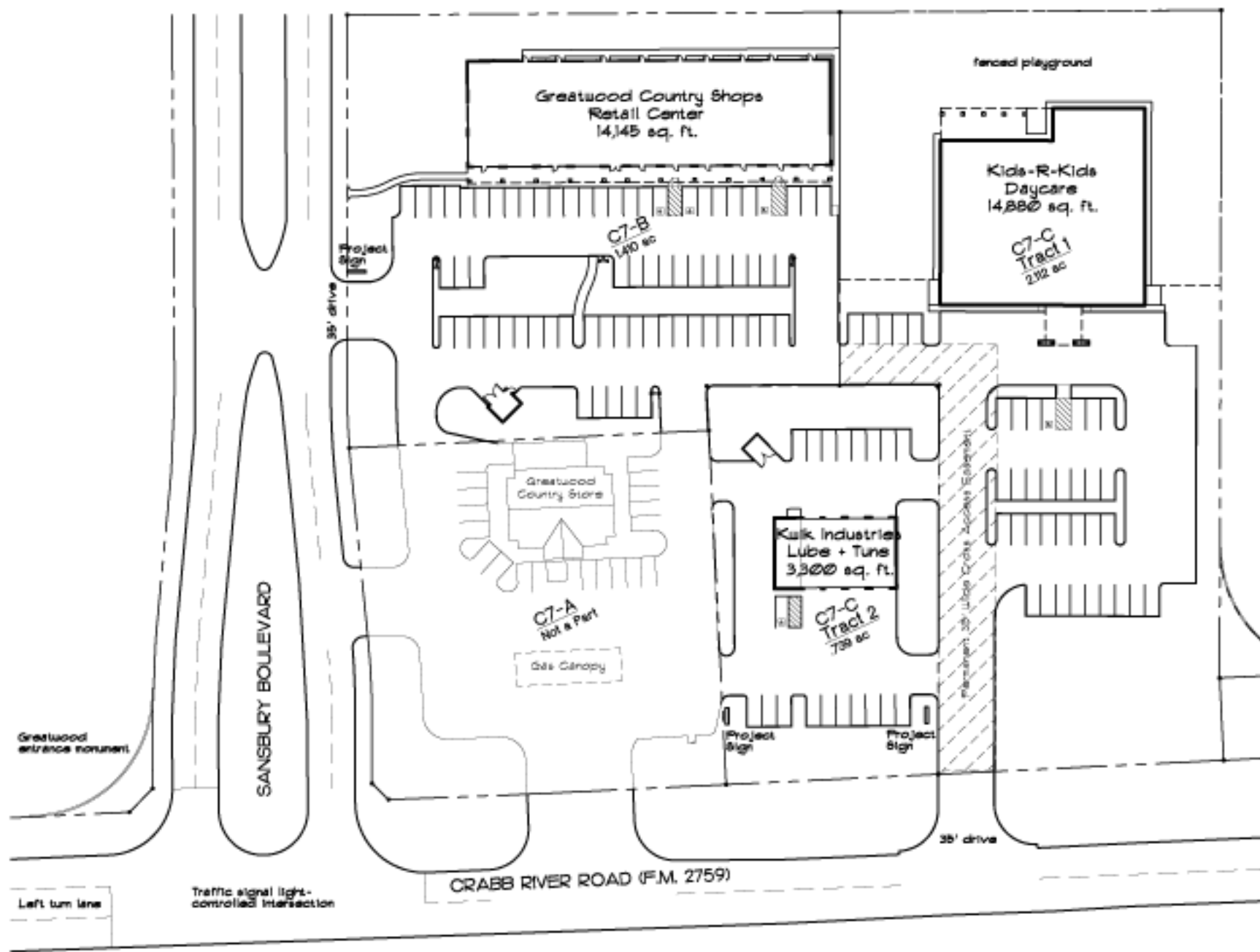

940741
10-11-02

Site Plan



FEHR GROSSMAN COX

Architects, Inc.
7400 Steele, Suite 100 Houston, Texas 77064
(713) 797-0400 Fax (713) 797-0740
Copyright © 1994 Fehr Grossman Cox Architects, Inc. All drawings and specifications, lines and design appearing hereon constitute the original and copyrighted work of the FGH, and the same may not be duplicated, used, or disclosed other than for the purpose of the original contract without the express written consent of the Firm.