

Proposed
**NEW LEASE BUILDING
 AT CINCO RANCH**

SITE DATA

RESERVE A

GROSS LAND AREA	0.8233 ACRES (35,863 S. F.)
GROSS BUILDING AREA	6,000 S.F.
PARKING	
PARKING SPACES	22 AUTOS (1 HC)
PARKING RATIO	3.6666 SPACES/MGA

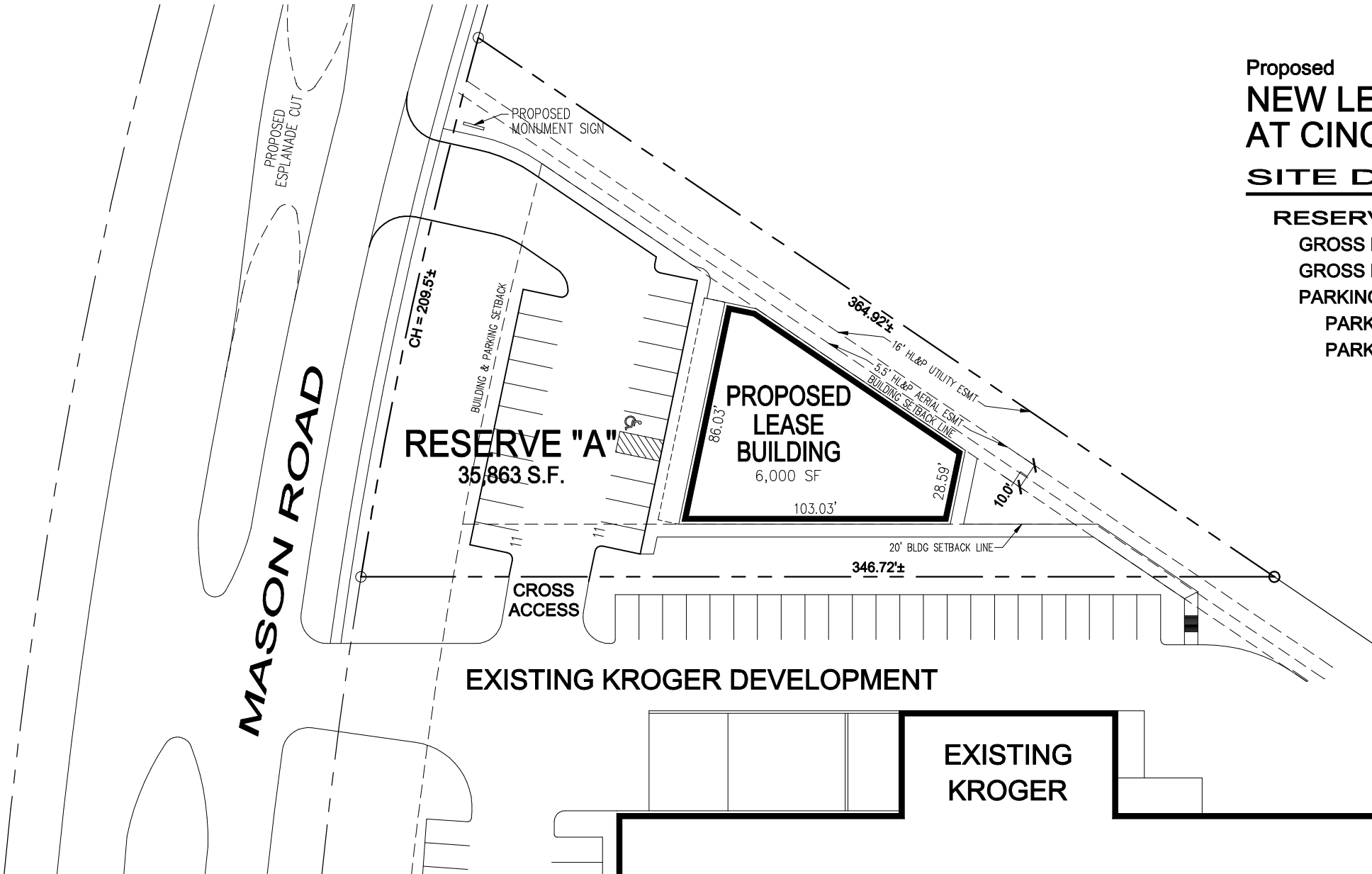

SCHEME 2.06

DATE: 12/8/2003

MASON & WESTHEIMER PARTNERSHIP, LTD

2401 FOUNTAINVIEW, SUITE 500
 HOUSTON, TEXAS 77057
 (713) 789-3600, FAX (713) 977-7288

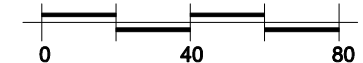

NORTH



Stephen R. Ritchey, AIA
 Architecture + Consulting